

Nova 2 Nova 2

- Höhen- und neigungsjustierbar
- Geeignet für Regalborde ab 24 mm
- Belastungsgruppe L50 (in Anlehnung an DIN 68874)
- Beutelverpackung möglich

- Height-and tilt adjustable
- Suitable for self panels from 24 mm thickness onwards
- Loading group L50 (DIN 66874)
- Bag packaging is possible

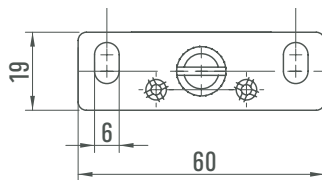

Nova 2 Nova 2

Ausführung
Type

Art. No.
Art. No.

Bolzen \varnothing 12 mm
Bolt \varnothing 12 mm

24.300.93

Bolzen \varnothing 10 mm
Bolt \varnothing 10 mm

24.300.94

Schraube \varnothing 5 x 50 mm
Screw \varnothing 5 x 50 mm

24.200.18

Dübel \varnothing 8 x 40 mm
Dowel \varnothing 8 x 40 mm

24.200.15

